

TYPAR® DRAINABLEWRAP™ PEEL AND STICK INSTALLATION GUIDE

HORIZONTAL WALL INSTALLATION

Install TYPAR® DrainableWrap™ Peel and Stick over an approved exterior sheathing, after the framing is complete and before the windows and doors have been installed. TYPAR DrainableWrap Peel and Stick is a self-adhered product and does not require any fasteners during installation. If the windows and doors have already been installed, trim the TYPAR DrainableWrap Peel and Stick close to the window frame and flash according to the TYPAR® flashing instructions. All installation procedures and techniques must comply with local code requirements and the latest version of ASTM 2112. Installation methods approved by the American Architectural Manufacturers Association (AAMA) are acceptable for TYPAR products and the TYPAR® Weather Protection System Lifetime Limited Warranty.*

STEP 1

Prepare the sheathing to be clean of dust and debris. For best practices, establish "level line" to use as a guide for top edge of TYPAR DrainableWrap Peel and Stick. Follow this level line as you roll out course to minimize wrinkles and ensure maximum adhesion to sheathing. TYPAR DrainableWrap Peel and Stick is comprised of an acrylic adhesive, and can be repositioned on sheathing to ensure a smooth, wrinkle-free application; however, ensure that the adhesive does not make contact with itself.

Start at the bottom of one end of the wall with the side without fiber facing up. When starting at a corner, overlap by a minimum of 6" (152 mm). A minimum of a 1" (25.4 mm) overlap on the sill plate is required; however, for maximum protection, a 2"-4" (51-102 mm) overlap on the sill plate is recommended.

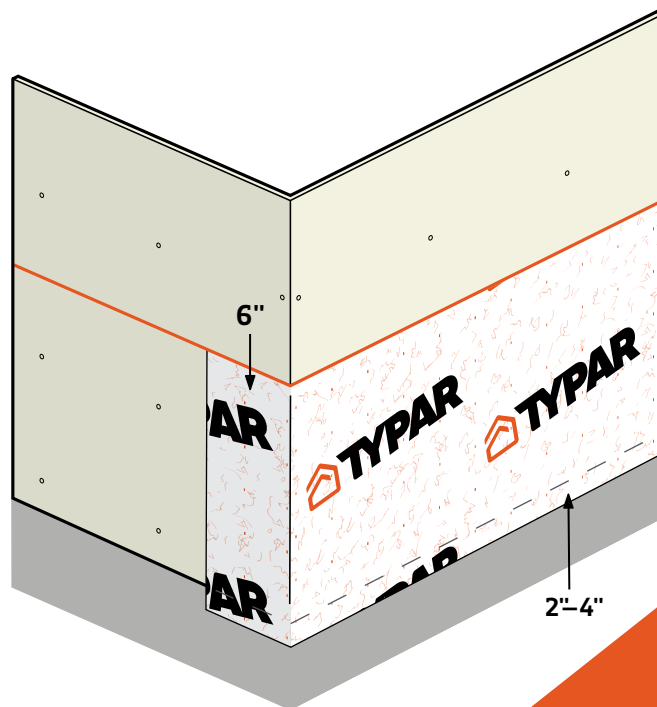
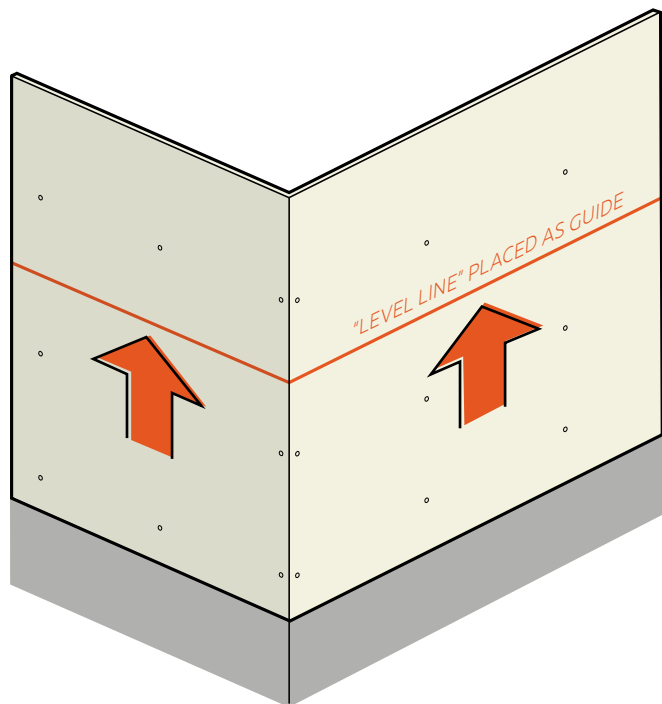

HORIZONTAL WALL INSTALLATION

STEP 2

Peel single release liner from TYPAR® DrainableWrap™ Peel and Stick and align top of membrane to level line. You may fasten the exposed corner with a plastic cap fastener to hold membrane in place as you continue to the next step. Press roll firmly into place on sheathing using hand pressure, with pressure applied first in middle of roll and working toward outer edges, removing any wrinkles and air bubbles in the process.

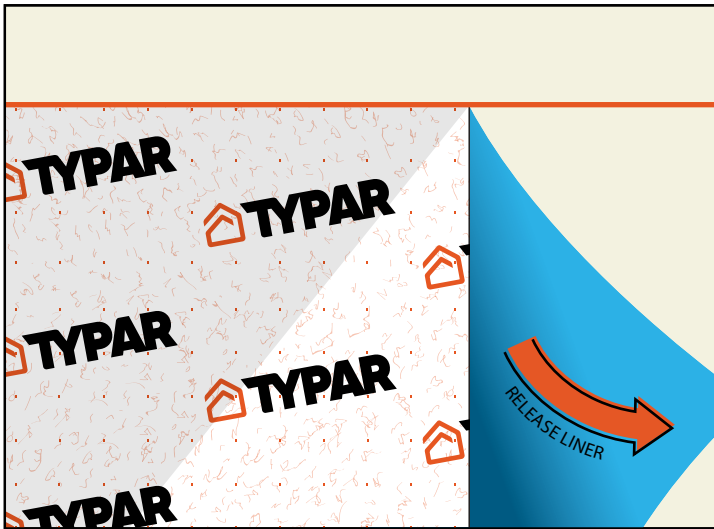

STEP 3

Continue unwinding roll, removing release liner and repeating hand pressure application until course is firmly applied to sheathing. For best practices, use a J-roller or other application tool to ensure any remaining wrinkles and air bubbles are removed from the course.

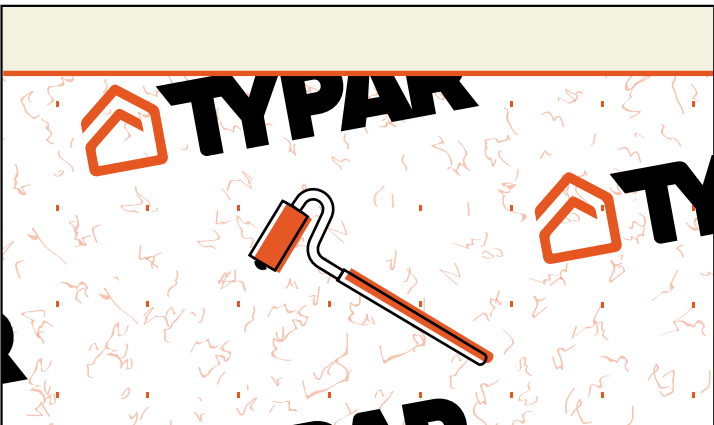

STEP 4

Repeat steps (2) and (3) for consecutive rolls, ensuring courses are applied in shingle lap fashion to properly shed water. Recommended overlap for horizontal and vertical applications is 4"-6" (102-152 mm). Use of TYPAR® Construction Tape on horizontal and vertical seams is optional.

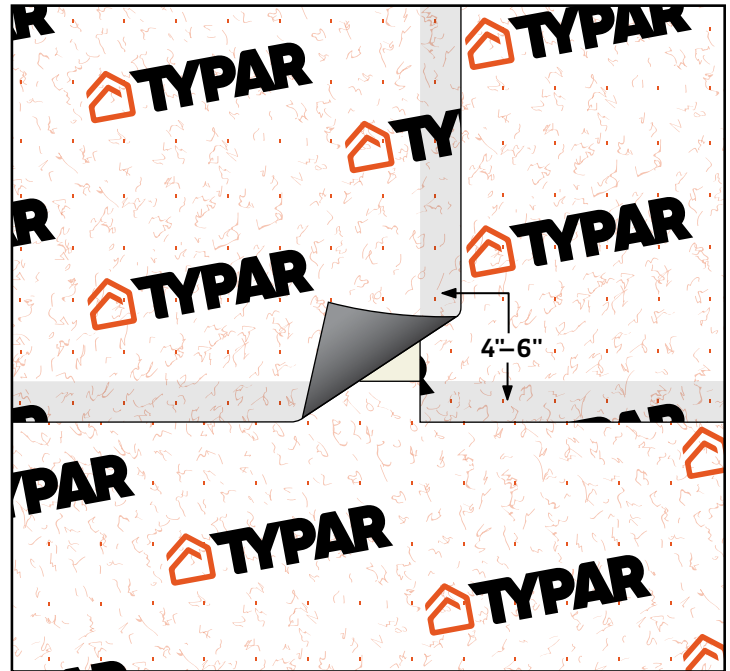

STEP 5

After the installation is complete, and before the exterior cladding is installed, inspect the TYPAR DrainableWrap Peel and Stick for tears. Repair the issues with TYPAR Construction Tape or TYPAR® flashing.

Do-It-Yourself Install? Exposed corners may be fastened with plastic cap fasteners to hold membrane in place as you roll out each course. Use of plastic cap fasteners is an approved installation accessory and will not void warranty coverage for the TYPAR DrainableWrap Peel and Stick under the TYPAR® Weather Protection System Lifetime Limited Warranty.*

*Certain limitations and exclusions apply. See the TYPAR Weather Protection System Limited Warranty located online at [TYPAR.com/downloads](https://www.typar.com/downloads) for full details.

